

# WorldKey

A world of opportunities in a single system



R&D by  **RFTech**

Unique advanced functionalities

## A private cashless payment system and a powerful customer management tool

The WorldKey system uses the MIFARE® (standard, Plus, DesFire, NFC) technology platform to ensure high safety standards and management of multiple applications. Security in transferring data is ensured by the combination of the proprietary encryption Mifare® and RFTech TDES (Triple Data Encryption Standard).

WorldKey allows you to manage several sales or identification applications (access to multiple services also of different operators), storing them on a single RFID support (card/key/tag/sticker). The applications can be used within a single infrastructure or extended to different businesses, either visibly or hidden. WorldKey supports the most used protocols (Executive, MDB, BDV) and is ready to integrate the Ethernet, RS485, CAN BUS, ccTalk and USB interfaces.

### Features

- System including one CPU unit and a reading device connected by a “smart” coaxial cable (patent pending)
- CPU equipped with micro USB port for firmware updating, configuration system, audit/log data collection, connection to the PC, for piloting an external device (USB in OTG “on the go” mode) and the Universal Hand-Held Programming Device
- Connecting ports for serial and parallel devices
- Compatible with KPM board
- Reading devices equipped with semaphore signals according to the EVA-CVS standard with 3 status LEDs and buzzer. Infrared interface for collecting audit/log data and programming the readers
- Supported vending protocols: Executive master/slave, MDB master/slave and BDV master/slave
- Cards/keys/tags identification upon first insertion into the CPU
- Possibility to connect 16 characters in 2 lines display
- Possibility to connect a WiFi module for audit data



Reading device available in 3 versions:

- **Moon:** for key/tag insertion. Supplied with two different front panels: round and oval, ideal for retrofitting
- **Sky:** for card/key/tag insertion
- **Galaxy:** for key/tag insertion and for cards in tap&go mode management

### Functionality

- Different prices management
- Sales prices (80x3 cashless prices + 80 cash prices)
- Single cash sales or multiple cash sales
- 3 security codes management (operator, rental, machine)
- Machine No. modifiable by the user
- Maximum value management
- Differentiated key management
- Black list/white list/log file management
- Time slots management
- Bonus management
- Accounting data management
- On-field firmware updating
- Remote management via Ethernet
- USB on the go
- CAN BUS connector
- RS485 connector
- Parallel banknote reader management
- Parallel coin validator management

### Tools

#### UNICO configuration program

For collecting and managing audit/log data (pursuant to the EVA-DTS standard or Windows Excel), programming operating parameters and managing all functions of the cards/keys/tags.

#### Software for card management (code RFT-CARD-SW)

#### Software for audit and log management (code RFT-AUDIT-SW)

#### Universal Hand-Held Device

To program WorldKey on-field or download the audit data via infrared connection.

#### Programming key and Clone programming key

#### Audit key



### Optional accessories

- Customisable RFID keys/tags/cards/stickers by quantity
- Credit Box for transferring credits
- LCD display
- Printer
- Countertop recharge box



## Technical Schematics



**Moon**  
Reading device for keys and tags  
Round front plate

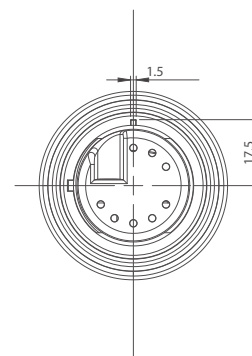
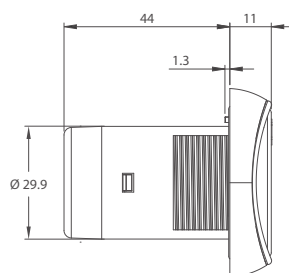
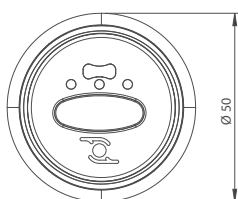

**Moon**  
Reading device for keys and tags  
Oval front plate

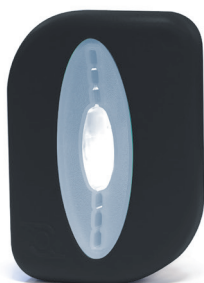
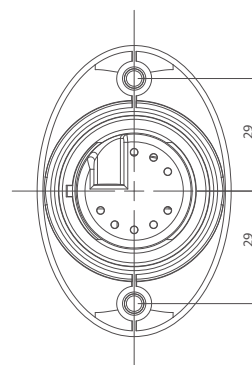
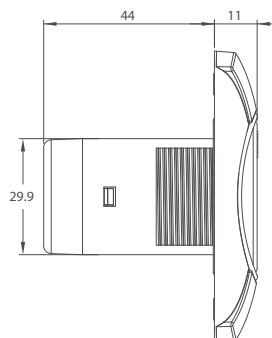
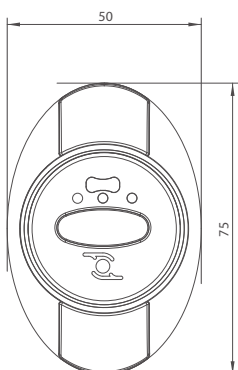

**Sky**  
Reading device for keys, tags  
and insertion cards

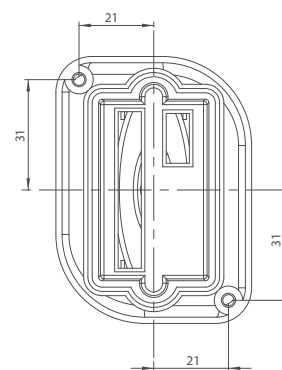
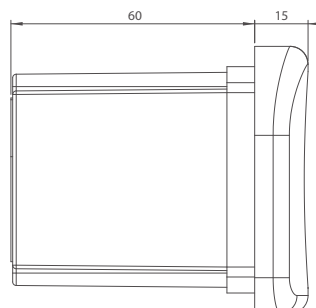
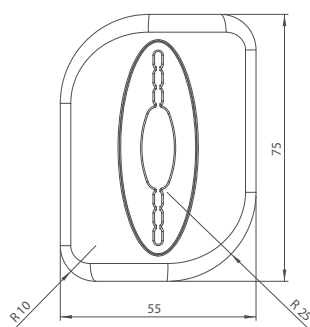

**Galaxy**  
Universal reading device  
for keys, tags and tap & go cards

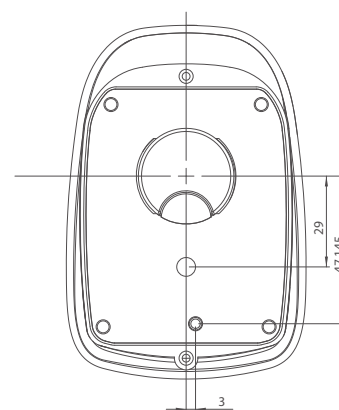
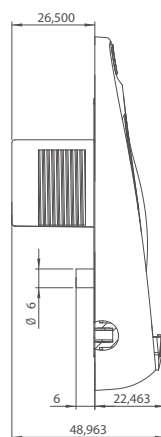
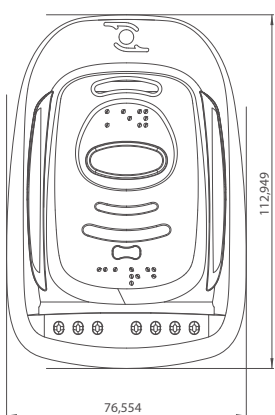



WorldKey  
CPU



Unit of measure: mm

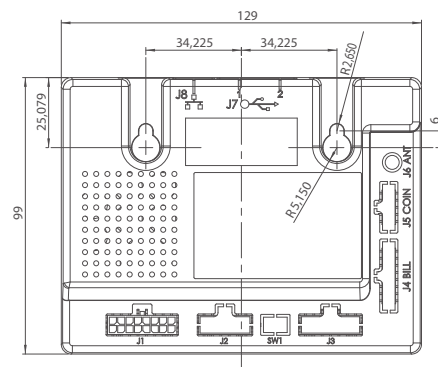

## Payment supports



Customisable **Keys** by quantity



Customisable **Cards** by quantity



Wide range of **Tags** available in different shapes and colours

## Technical Specifications - CPU

|                          |                                  |
|--------------------------|----------------------------------|
| Dimensions (LxHxW)       | 129 x 99 x 28 mm                 |
| Weight                   | 200 g                            |
| Power supply             | 15-40 Vdc - 12-27 Vac (50-60 Hz) |
| Power consumption        | 3.75W without peripherals        |
| Operating temperature    | -20 °C ÷ 50 °C                   |
| Humidity (non-condensed) | 90%                              |
| Storage temperature      | -20 °C ÷ 70 °C                   |



Customisable **Stickers** by quantity



**Happy:** new customisable tags by quantity

## Technical Specifications Reading devices

|                          | Moon<br>(Round front plate) | Moon<br>(Oval front plate) | Sky             | Galaxy           |
|--------------------------|-----------------------------|----------------------------|-----------------|------------------|
| Dimensions (LxHxW)       | 50 x 50 x 55 mm             | 50 x 75 x 55 mm            | 55 x 75 x 75 mm | 77 x 113 x 50 mm |
| Weight                   | 45 g                        | 45 g                       | 60 g            | 90 g             |
| Operating temperature    | -20 °C ÷ 50 °C              | -20 °C ÷ 50 °C             | -20 °C ÷ 50 °C  | -20 °C ÷ 50 °C   |
| Humidity (non-condensed) | 90%                         | 90%                        | 90%             | 90%              |
| Storage temperature      | -20 °C ÷ 70 °C              | -20 °C ÷ 70 °C             | -20 °C ÷ 70 °C  | -20 °C ÷ 70 °C   |

## Technical Specifications - keys/cards/tags

|                        |  |
|------------------------|--|
| Technology used        | ISO 14443 – MIFARE® encrypted data and energy induction transmission |
| Transmission frequency | 13.56 MHz  |